

POLYSTYRENE CORE

.120 FRP PANEL

- PANELS ARE CONSTRUCTED WITH 2 VC-95 .120 FACE SHEET MATERIAL.
- INSULATED PANELS HAVE CORE MATERIAL OF 25 PSI POLYSTYRENE WITH A MAXIMUM FLAME SPREAD OF 25.
- IT'S CORE DOES NOT EMIT TOXIC GASES WHEN IGNITED.
- PANELS MAY BE USED IN ALUMINUM ENTRANCES TO INCREASE SECURITY AND PRIVACY IN LIEU OF CLEAR GLAZING.

VALE 1 3/4" FRP PANEL

MODEL: VC100 - 175

VALE DOORS 2010

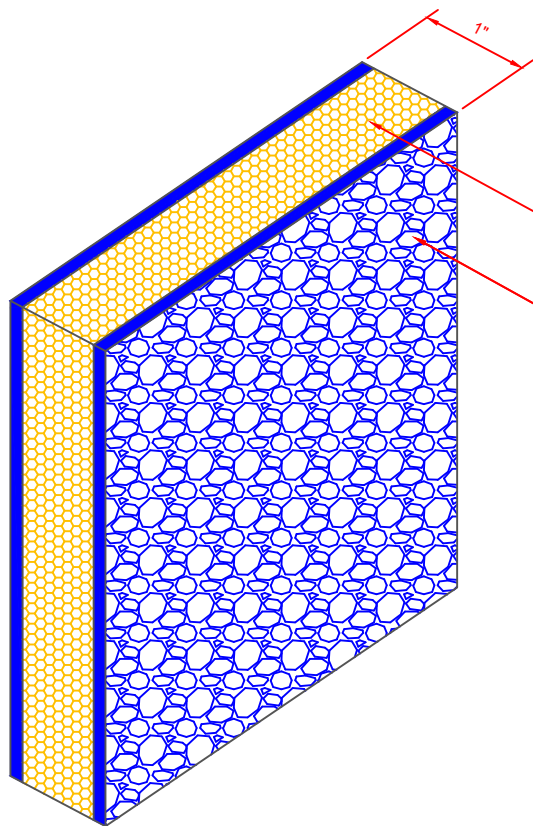

POLYSTYRENE CORE

.120 FRP PANEL

- PANELS ARE CONSTRUCTED WITH 2 VC-95 .120" FACE SHEET MATERIAL.
- INSULATED PANELS HAVE CORE MATERIALS OF 25 PSI POLYSTYRENE.
- IT'S CORE DOES NOT EMIT TOXIC GASES WHEN IGNITED.
- PANELS MAY BE USED IN ALUMINUM ENTRANCES TO INCREASE SECURITY AND PRIVACY IN LIEU OF CLEAR GLAZING.
- THE MODEL VC-100-100 1" PANEL CAN BE EMPLOYED TO CREATE A TWO-TONE LOOK IN VARIOUS FRP DOOR STYLES

VALE 1" FRP PANEL

MODEL: VC100 - 100

VALE DOORS 2010

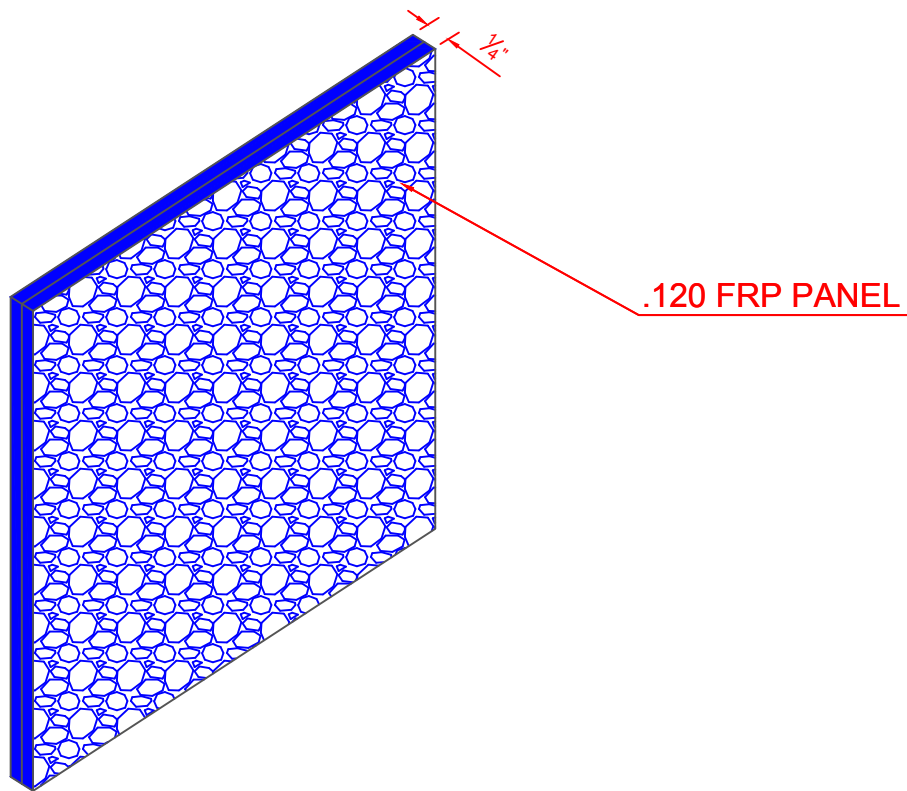

VALE $\frac{1}{4}$ " FRP PANEL

MODEL: VC100 - 75

VALE DOORS 2010

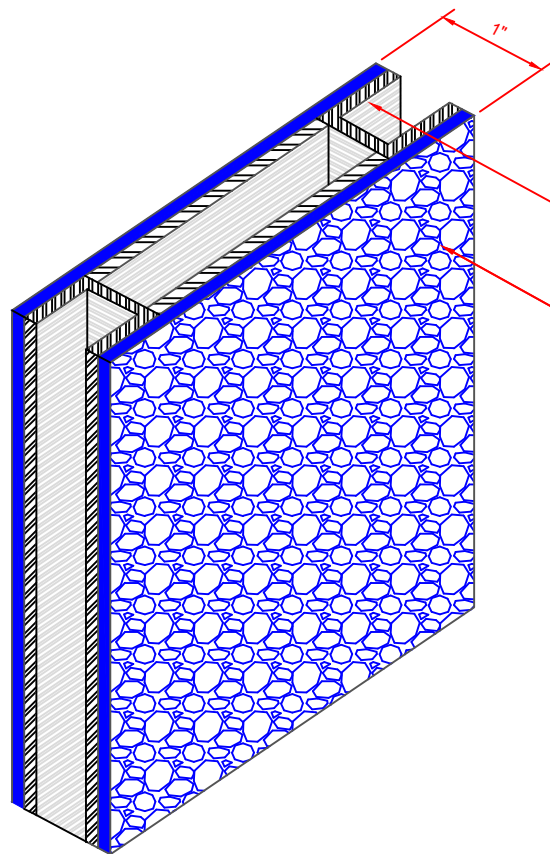

3/4" ALUMINUM "C" CHANNEL

.120 FRP PANEL

- PANELS ARE CONSTRUCTED WITH 2 VC-95 .120" FACE SHEET MATERIAL.
- INSULATED PANELS HAVE CORE MATERIAL OF 25 PSI POLYSTYRENE WITH A MAXIMUM FLAME SPREAD OF 25.
- IT'S CORE DOES NOT EMIT TOXIC GASES WHEN IGNITED.
- PANELS MAY BE USED IN ALUMINUM ENTRANCES TO INCREASE SECURITY AND PRIVACY IN LIEU OF CLEAR GLAZING.

VALE 1" FRP PANEL

MODEL: VC100 HD

VALE DOORS 2010

VALE 1" ALUMINUM REINFORCED PANEL